

ANDERSON, C.E. ADD.	18
ANDERSON, JOHN H. ADD.	8-9
ARMSTRONG, CAROL B. CO. ADD.	20-21
ARMSTRONG, WILLIAM H. ADD.	19
ARMSTRONG, W.W. Sub-Div. of Lot 19	18
ARMSTRONG Sub-Div. of Lot 19 (Plate 3rd)	18
AUSTIN ADD.	1-2
AVELLE ADD.	3
BARNARD-COWEN ADD.	24
BARNARD-COWEN-HAMMOND ADD.	23-25-26
BARNARD 1st. ADD.	24
BARNARD 2nd. ADD.	24-25-26-27-28
BARNARD 3rd. ADD.	25-24-25-26
BELLAIRE CITY	19-20
BELLAIRE PLAT. of	11
BELLAIRE SAL. WORKS ADD.	24
BYTES ADD.	25-28
CUMMINS 1st. ADD.	28
CUMMINS 2nd. ADD.	28
CUMMINS 3rd. ADD.	28
CUMMINS 4th. ADD.	28-29
DAVIS ADD.	27, 28
DUNFEE ADD.	11
EDGEHILL ADD.	29-30-31
ELKAN REAL ESTATE ADD.	28-29
FINKS 1st. ADD. (South Bellaire)	10-11
FINKS 2nd. ADD.	10
FINKS 3rd. ADD.	10
FINKS 4th. ADD.	9-10
FLORENCE ADD.	8
FOLMAR-ROBBIE ADD.	8
GRANDVIEW ADD.	9
GRANDVIEW & DUDLEYS ADD.	11
HARRIS PARK ADD.	11
HEATHERSTONES 1st. ADD.	10
HEATHERSTONES 2nd. ADD.	4-10
HEATHERSTONES 3rd. ADD.	4-10
HEATHERSTONES 4th. ADD.	3-4
HORNS 1st. ADD.	23-24
HOLLYS Sub-Div. of Lot 10	20-21
HOLLYS ADD. To West Bellaire	18
KEYSER, L.E. ADD. To Bellview (Block A)	6
KEYSER, L.E. ADD. To Bellview (Block B)	6
KEYSER, JOHN T. 2nd. ADD.	6
LIWOOD ADD.	7-8-13-14-16-17
NORMAN 1st. ADD.	21
NORMAN 2nd. ADD.	21
PELLIS LOTS	21
ROBINSON-ANDERSON-MELOTT ADD.	14-15
ROBINSON & McCLAIN ADD.	21
ROSEBUSH ADD.	1
ROSEPER 1st.	20
ROSEPER 2nd.	20
ROSEPER 3rd.	20-24
ROSEPER-ROBINSON 1st. ADD.	22
ROSEPER-ROBINSON 2nd. ADD.	22
ROSEPER-ROBINSON 3rd. ADD.	22-23
SHEETS ADD.	24
SULLIVAN-BARNARD-COWEN ADD.	18-21
SULLIVAN-BARNARD-COWEN 2nd. ADD.	18-21
SULLIVAN-BARNARD-COWEN Sub-Div. of Out-Lot 1	18-21
SULLIVAN, Mrs. J.M. ROSE HILL ADD.	18
WEST BELLAIRE (Robinson Anderson Melott)	14-15-16

CITY OF
BELLAIRE
BELMONT COUNTY
OHIO

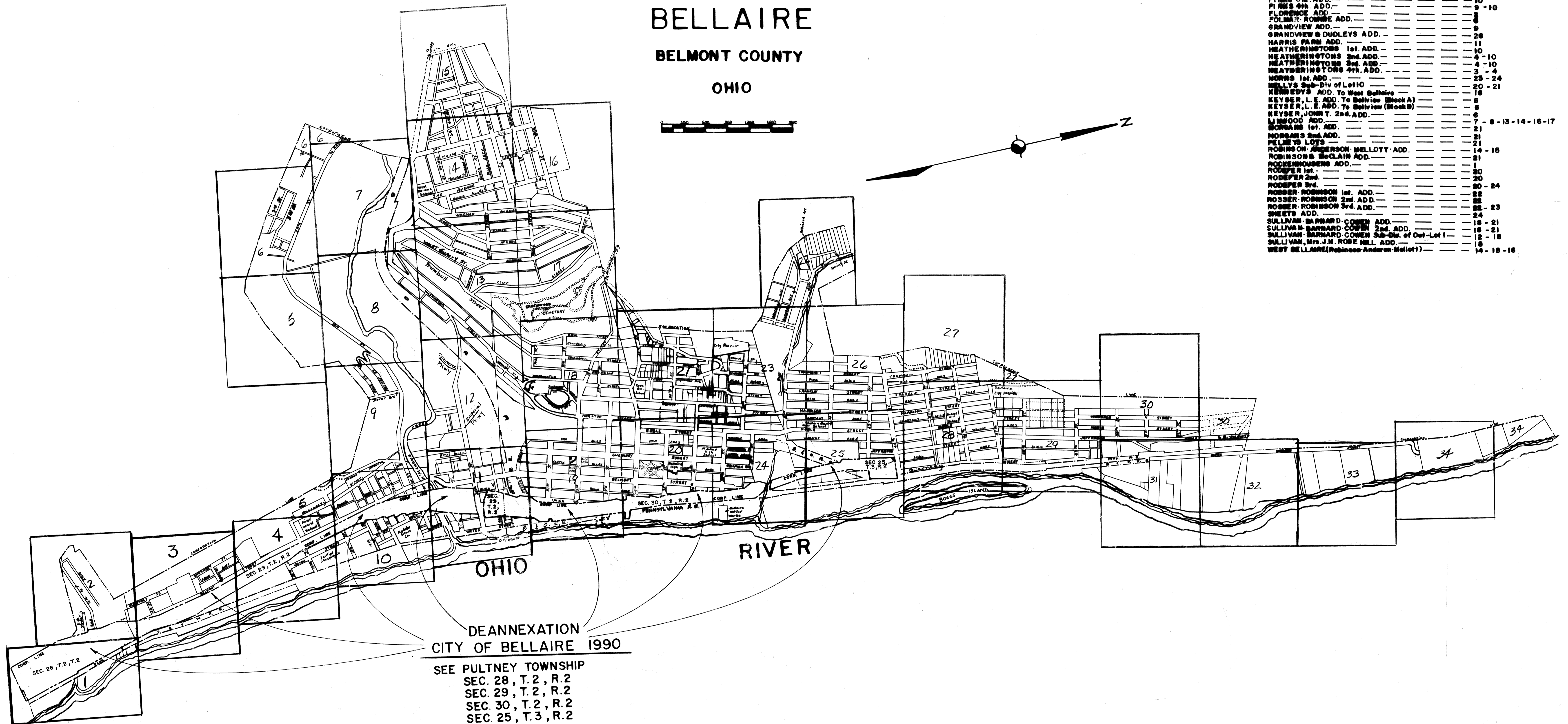
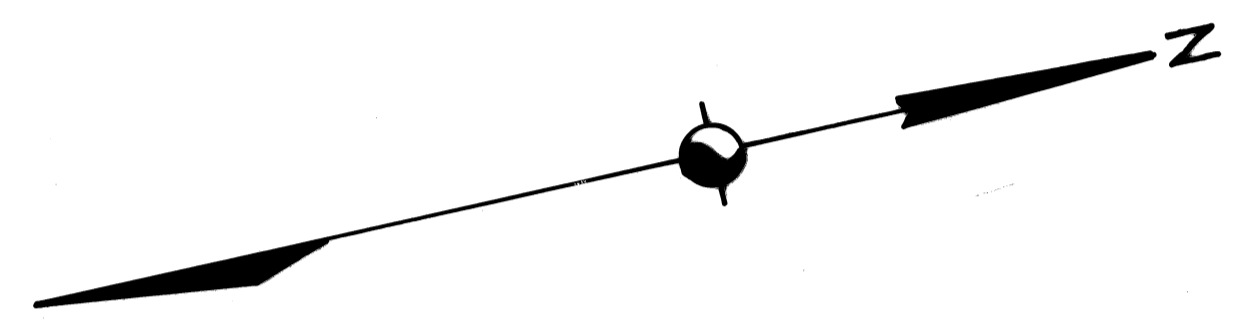

FRED F BENNETT
BELMONT COUNTY ENGINEER
1966